

PREVIOUS SCHEME FOOTPRINT
REF-09/0821/FUL

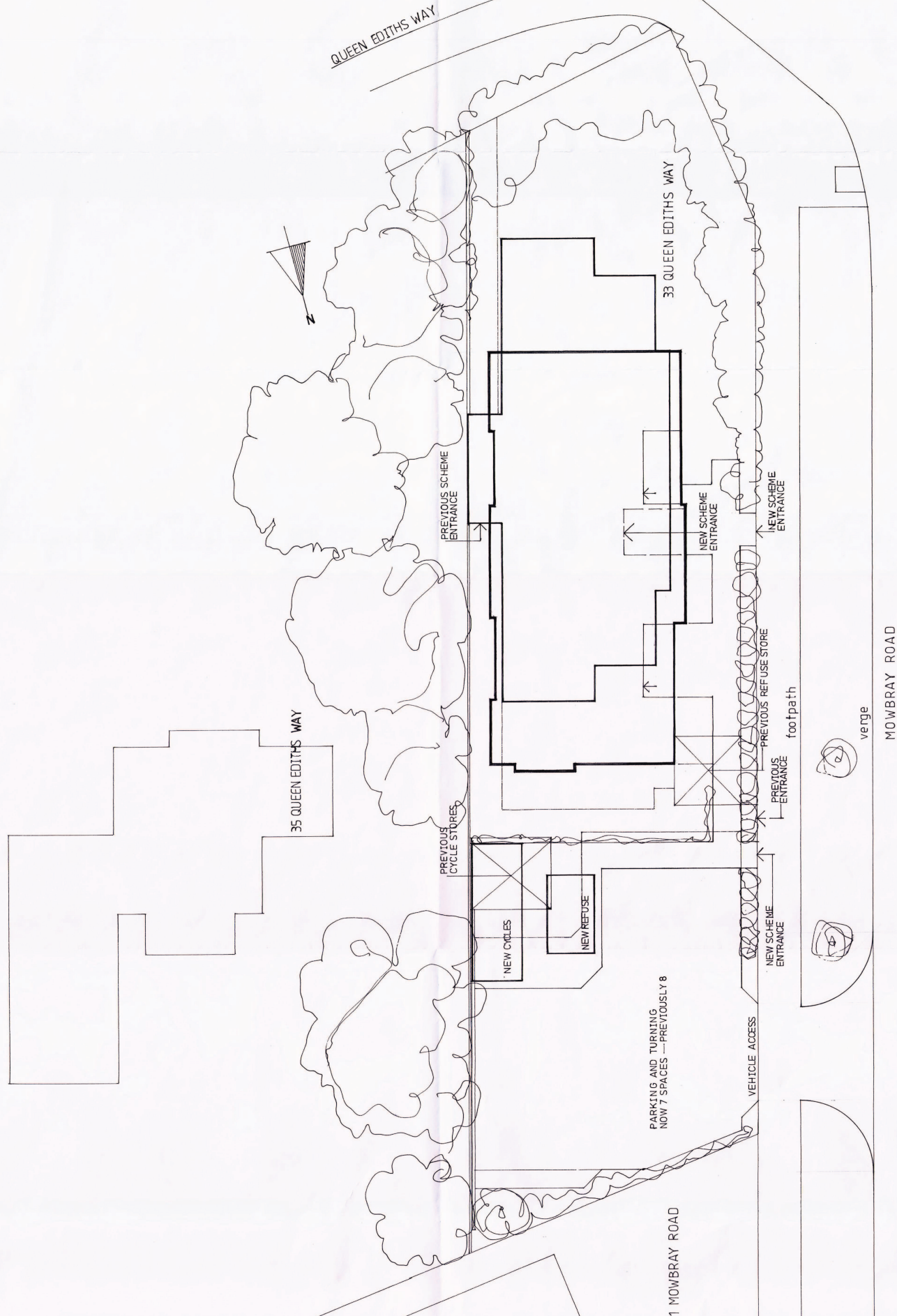

NEW SCHEME FOOTPRINT
REF-12/1223/FUL



33 QUEEN EDITHS WAY
CAMBRIDGE

PREVIOUS/NEW SITE PLAN

Client
MR and MRS M MUNNELLY

Merrie and Partners,
Architects
51 Newnham Road, Cambridge, CB3 9EY
Tel: 01223 351696 Fax: 01223 351698
This drawing and any designs shown upon it is the copyright of
Merrie and Partners and shall not be reproduced, copied or
reproduced without their written consent.

Drwg no
XC 139. 25

scale
1 100

date
10.5.2013